

PLAIN EYE BOLT

316-NM STAINLESS STEEL

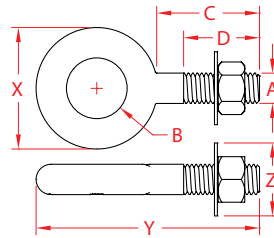

Import



Drop Forged



Precision Machined



Load Rated



Suncor Exclusive

ITEM	A (size)	B	C	D	X (height)	Y (length)	Z (width)	WLL (lb)	WT (lb)	PACKAGING TYPE	EACH (qty)	INNER (qty)	CARTON (qty)	UPC
S0315-0705	1/4"	0.50"	2.00"	1.50"	1.03"	3.08"	0.46"	500	0.06	POLYBAG	1	10	200	791506040514
S0315-0710	1/4"	0.50"	4.00"	2.50"	1.03"	5.07"	0.46"	500	0.09	POLYBAG	1	10	200	791506040538
S0315-0806	5/16"	0.63"	2.25"	1.50"	1.18"	3.50"	0.61"	800	0.10	POLYBAG	1	10	100	791506040569
S0315-0810	5/16"	0.63"	4.25"	2.50"	1.18"	5.50"	0.61"	800	0.14	POLYBAG	1	10	100	791506040583
S0315-1002	3/8"	0.75"	0.75"	0.75"	1.50"	2.35"	0.76"	1,200	0.15	POLYBAG	1	10	100	791506040606
S0315-1006	3/8"	0.75"	2.50"	1.50"	1.50"	4.10"	0.76"	1,200	0.20	POLYBAG	1	10	100	791506040637
S0315-1012	3/8"	0.75"	4.50"	2.50"	1.50"	6.05"	0.76"	1,200	0.26	POLYBAG	1	10	100	791506040651
S0315-1304	1/2"	1.00"	1.50"	1.25"	2.02"	3.65"	0.93"	2,150	0.38	POLYBAG	1	1	50	791506040675
S0315-1308	1/2"	1.00"	3.25"	1.50"	2.02"	5.40"	0.93"	2,150	0.49	POLYBAG	1	1	50	791506040699
S0315-1315	1/2"	1.00"	6.00"	3.00"	2.02"	8.20"	0.93"	2,150	0.63	POLYBAG	1	1	50	791506040712
S0315-1603	5/8"	1.25"	1.00"	0.75"	2.52"	3.60"	1.17"	3,440	0.70	POLYBAG	1	1	20	791506040736
S0315-1605	5/8"	1.25"	2.00"	1.75"	2.52"	4.65"	1.17"	3,440	0.80	POLYBAG	1	1	20	791506040750
S0315-1610	5/8"	1.25"	4.00"	2.00"	2.52"	6.60"	1.17"	3,440	0.95	POLYBAG	1	1	20	791506040774
S0315-1615	5/8"	1.25"	6.00"	3.00"	2.52"	8.60"	1.17"	3,440	1.12	POLYBAG	1	1	20	791506040798
S0315-2003	3/4"	1.50"	1.00"	0.88"	2.90"	4.00"	1.45	5,140	1.06	POLYBAG	1	1	10	791506040811
S0315-2005	3/4"	1.50"	2.00"	1.75"	2.90"	4.98"	1.44"	5,140	1.13	POLYBAG	1	1	10	791506040835
S0315-2012	3/4"	1.50"	4.50"	2.00"	2.90"	7.50"	1.44"	5,140	1.46	POLYBAG	1	1	10	791506040859
S0315-2015	3/4"	1.50"	6.00"	3.00"	2.90"	8.90"	1.44"	5,140	1.60	POLYBAG	1	1	10	791506040873
S0315-2213	7/8"	1.75"	5.00"	2.50"	3.40"	8.55"	1.50"	7,130	2.15	POLYBAG	1	1	10	791506040897
S0315-2504	1"	2.00"	1.44"	1.38"	4.00"	5.75"	1.72"	9,370	2.76	POLYBAG	1	1	5	791506040910
S0315-2506	1"	2.00"	2.50"	2.25"	4.00"	7.00"	1.72"	9,370	3.14	POLYBAG	1	1	5	791506040934
S0315-2515	1"	2.00"	6.00"	3.00"	4.00"	10.25"	1.72"	9,370	3.96	POLYBAG	1	1	5	791506040958

NOTE:
MEETS ASME B30.26-2010 SECTION 26-2.0. EYE BOLTS HAVE FORGED MARKINGS OF 316-NM, SIZE AND WLL IN TONS. ALL THREADS ARE "UNC".
ONE NUT AND WASHER ARE INCLUDED. EXTRA NUTS AND WASHERS ARE AVAILABLE FROM STOCK. SHAFT IS MACHINED FOR PERFECT FIT AND SEATING.
ALL DIMENSIONS ARE NOMINAL (+/- 3%) AND ARE SUBJECT TO CHANGE WITHOUT NOTICE.